

IN CASE OF FIRE

LEAVE BUILDING THROUGH
THE NEAREST EXIT AND REMAIN A
SAFE DISTANCE AWAY
UNTIL ALL IS CLEAR

IN CASE OF HIGH WIND

LEAVE BUILDING AND MOVE TO THE
EAST LOBBY OF BLDG. 120 / COVELLE HALL
AND THEN UNDER THE AUDITORIUM STAIRS
REMAINING THERE UNTIL ALL IS CLEAR

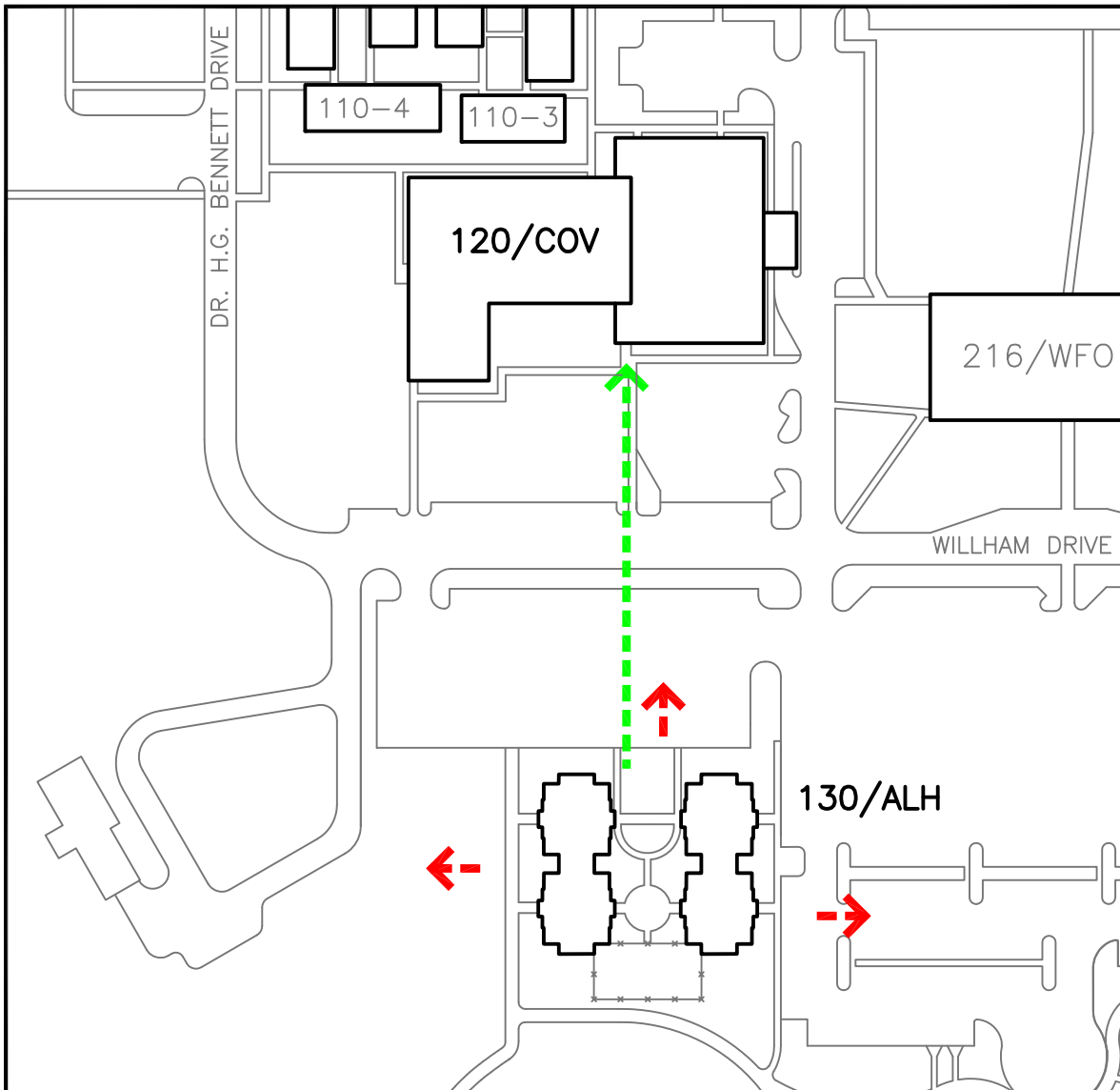

NORTH

BLDG. 130 / ALEXANDER HALL - EVACUATION PLAN

DATE: 4/8/15

FILENAME: 130FEP